



Sunseeker 65 Sport Yacht - 4102265

£ 3,067,619 GBP Ex Tax



Boat Details	<div><div>Make</div><div>Sunseeker</div></div>	<div><div>Model</div><div>65 Sport Yacht</div></div>	<div><div>Model Year</div><div>2022</div></div>	<div><div>Location</div><div>Spain</div></div>	<div><div>Max Speed*</div><div>35 knots</div></div>
Engines	<div><div>Details</div><div>2 x Volvo Penta IPS 1350</div></div>	<div><div>Engine HP</div><div>1000</div></div>	<div><div>Drive Type</div><div>Pod Drive</div></div>	<div><div>Fuel Type</div><div>Diesel</div></div>	<div><div>Range</div><div>750 Nm</div></div>
Dimensions	<div><div>LOA</div><div>20.5m/67ft 3in</div></div>	<div><div>Draft</div><div>1.6m/5ft 3in</div></div>	<div><div>Beam</div><div>5.1m/16ft 9in</div></div>	<div><div>Weight</div><div>37810kg/37.81t</div></div>	
Tankage	<div><div>Fuel Capacity</div><div>3500l</div></div>	<div><div>Water Capacity</div><div>800l</div></div>	<div><div>Black Water Capacity</div><div>200l</div></div>		
Accommodation	<div><div>Cabins</div><div>3</div></div>	<div><div>Guests</div><div>6 Berth(s)</div></div>	<div><div>Heads</div><div>4</div></div>	<div><div>Crew Cabins</div><div>1</div></div>	<div><div>Crew</div><div>2 Berth(s)</div></div>

\*Performance details are intended as a guide only and are not binding and do not constitute part of any terms and conditions.





## Description

With a sleek exterior profile of carbon fibre and polished stainless steel, the 65 Sport Yacht balances the traditional with hi-tech to place emotion and performance at its heart.

The modular layout allows for a variety of specifications and enhancements, with space that adapts seamlessly to all kinds of socialising and adrenaline-seeking.

Take your Sport Yacht to new heights by carrying the tender on the bathing platform and reconfiguring the vacated space as a dedicated 'Beach Club' – with direct sea access, bar, fridge, BBQ, and free-standing seating. The perfect space for those happiest close to the water.

With speeds of up to 35 knots, the 65 Sport Yacht cuts an equally impressive figure on the open water. Taken all together, the experience is one of pure adrenaline, akin to driving a high performance convertible supercar and absolutely unique.

## Accommodation

Three cabins – including a full beam master stateroom – accommodate up to six guests in luxurious comfort, with a fully appointed crew cabin located forward of the garage.





### **Platinum Mediterranean Package**

Sky-helm Second helm with duplicate Nav and engine controls.  
Air Conditioning Tropical specification with second shore power inlet.  
Generator Onan 17.5kW upgrade.  
Flexiteek composite decking on the Sky Deck.  
Hydraulic Telescopic gangway with teak grate walkway.  
Fresh water deck wash system.  
Electric canopy for aft cockpit.  
Tender recovery roller system.  
Additional aft pair of 12" Spring Mooring cleats.  
Upgraded Black Water tank.  
Large Grey water storage tank option.  
Dimmer switches on interior and exterior overhead lighting.  
Bow Sunbathing Cushions with folding back rests.

### **Performance Entertainment Package**

1. Saloon Samsung 55" Smart 4K QLED Television with Apple TV App and Airplay 2 with 4K Blu-ray player. Sonos Amp connecting TV with the built in B&W CCM362 speakers allowing music streaming.  
2. Master cabin Samsung 55" Smart 4K QLED Television with Apple TV App and Airplay 2 included. Sonos Amp connecting TV with the built in B&W CCM362 speakers allowing music streaming.  
3. Forward cabin Samsung 43" Smart 4K QLED Television with Apple TV App and Airplay 2 included. Sonos Amp connecting TV with the built in B&W CCM362 speakers allowing music streaming.  
4. Mid Cabin 24" Smart HD Television with Apple TV. Sonos Amp connecting TV

with the built in B&W CCM362 speakers allowing music streaming.

5. Cockpit Sonos Amp connecting two Sonance VPXT6R marine speakers allowing music streaming. Foredeck Sonos Amp connecting two Sonance VPXT6R marine speakers allowing music streaming. Flybridge Sonos Amp connecting Four Sonance VPXT6R marine speakers allowing music streaming.  
Note. The router is to provide access to the internet via Wi-fi or Cellular data and to allow the user to link to an available marina Wi-fi network. The boat can be fitted with up to 2 SIM cards (user supplied) to access the internet when in range of 3G-4G data signals. This system will give data communications only. Voice communication is not covered. Air time, service agreements and SIM cards shall be the responsibility of the Client. iPad mini is included. Network access available throughout the boat. Includes network connection to saloon and all guest cabin TVs.

### **Navigation Systems**

Two Volvo Penta Glass Cockpit MFD 16" Multifunctional Colour Radar Chartplotter.  
Garmin GSD 25 fishfinder sounder module with through hull depth, temp and speed transducer B744V.  
Volvo Penta integrated pilot system for IPS.  
Garmin GRM Phantom 24 Radome Radar antenna and GPS19x antenna.  
Garmin AIS 800 Class B AIS transceiver.

### **Other Extras**

Crew Cabin fit out installation.  
Sky-light with fixed glass.

Navigation equipment to be sprayed LSA Jet black.  
Compass Swinging and adjustment with correction card.  
Crew cabin Air Conditioning 6,000 BTU.  
Television to be fitted on a fall and rise lifting system.  
Vitrifrigo Freezer C110BT in the Upper Galley.  
Wine cooler for 33 bottles fitted in the lower lobby understairs cupboard  
Miele WTF121 Washer-Dryer in the Crew area.  
Webasto Isotherm Cruise 36 24V 36 litre capacity drawer refrigerator with stainless steel front on the Sky Deck.  
Optional Cockpit wet-bar with sink lieu of Cockpit bar stools.  
Icemaker - Vitrifrigo IM Classic Hydro in the cockpit.  
Icemaker - Vitrifrigo IM Classic Hydro in the Lower Lobby.  
Marine Electric BBQ kenyon Grill fitted in the wet bar.  
Stern docking Winches - TM3 1100 800W 24V capstan fitted port and starboard in the Aft Cockpit.  
Exterior Feature white LED strip lighting along the side deck and fore deck.  
Underwater lights - Lumishore LED x 4 - Dual colour white / Blue  
Stainless steel heated towel rails in the Master and Forward Toilet Compartment.  
Seakeeper 16 anti-roll gyro stabiliser.  
Lewmar 40Kg Delta Galvanised Anchor and 90 Metres of 10mm Galvanised anchor chain.  
Raindance garage door overhead platform shower with courtesy lighting.  
Flexiteek composite decking for the side and fore deck (Teak Colour).  
Flexiteek composite decking in the Garage space (Teak Colour).  
Protective Covers Package - Foredeck sunpad and seating cover, aft cockpit

sunpad cover, aft cockpit seating cover, aft cockpit table cover, Sky Deck covers.  
Interior Wood Finish - Silver Oak Low build open grain Satin Finish.  
Dometic Safe MD 281C concealed in cabinetry (8.2 lts. W280mm x H165mm x D235mm) for the Master Cabin.  
Vitrifrigo Refrigerator with freezer compartment in the Lower Lobby  
Preparation for future installation of a Water Maker. Seacock and outlets blanked off. Fresh water feed to tank. Power supply.  
Integrated Slimline Dishwasher in the Galley  
Sunbrella performance exterior upholstery upgrade  
Wood flooring in lower lobby and step to the master cabin and the forward lobby up to the forward cabin door  
Interior Upgrade Collection - Fabrics and Linings chosen from the Platinum Collection  
Carpet upgrade to Havana White Rum  
Optional port side arrangement. Two upholstered seats and central breakfast table.  
Lobby Stair Risers to be finished in Opti Grey Mirror in Lieu of the standard wood finish.  
All Guest Cabins to have Roman Blinds in James Hare Java - 31646/09 BarkJac Silver Frost with Blackout Lining  
Full sea and systems commissioning  
Cost of export Shipping to Mallorca, Spain  
Class XII safety kit for vessel based on 8 person. Safety kit can be modified to suit use and location of vessel (price may vary).



[Click Here to view 360 Virtual Tour](#)





























7 - Side Deck









9 - Flybridge





10 - Bathing Platform









12 - Aft Cockpit





13 - Aft Cockpit









15 - Saloon





16 - Saloon





17 - Galley













20 - Master Cabin





21 - Master Cabin





22 - Master Cabin













25 - VIP Cabin









27 - Guest Twin Cabin









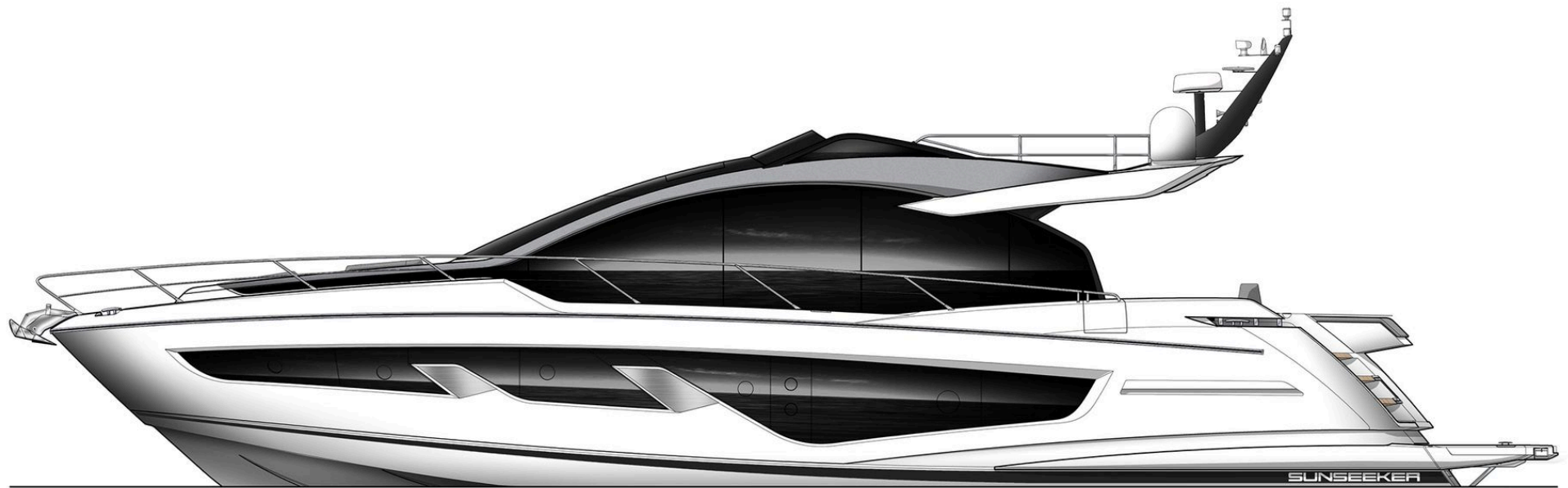



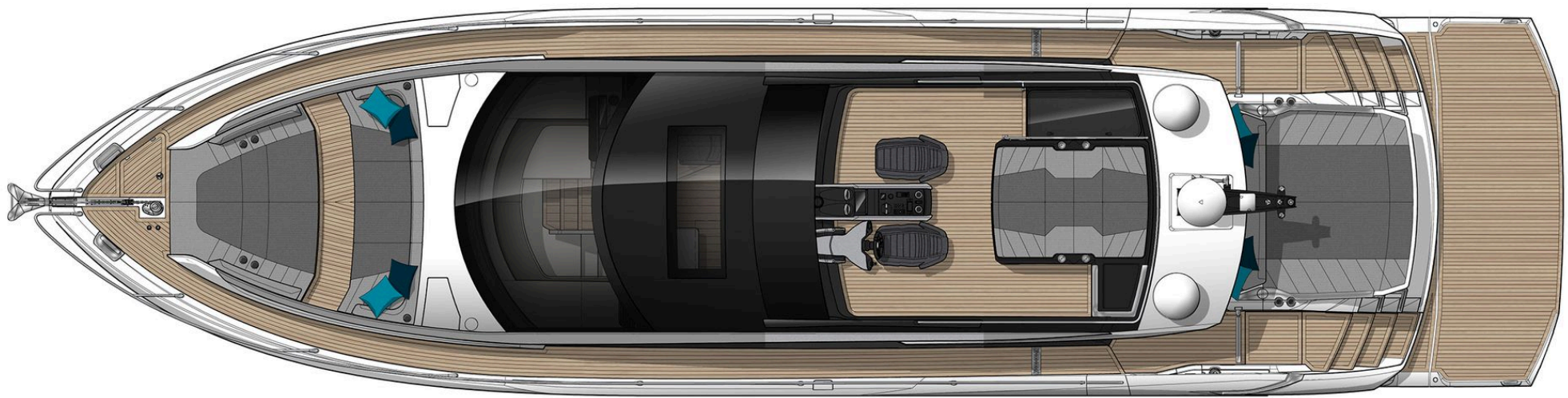



Layout - Main Deck





## Layout - Main Deck Options

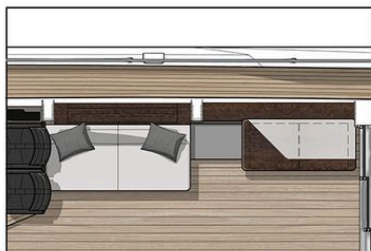

MAIN DECK OPTION  
Shown with std side sofa with  
rise & fall TV outboard



MAIN DECK OPTION  
Shown with extended port side seating to suit  
Lower Deck Galley arrangement

MAIN DECK OPTION  
Shown with port side cockpit wetbar

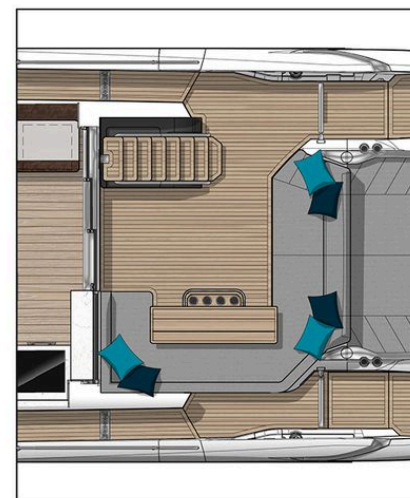
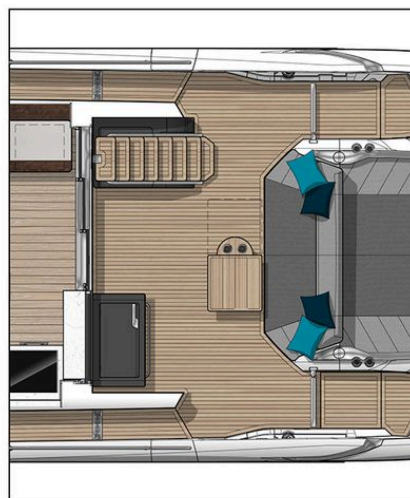

MAIN DECK OPTION  
Shown with extended cockpit  
seating arrangement



Layout - Lower Deck







LOWER DECK OPTION

Extended Master Stateroom with entrance office area



LOWER DECK OPTION

Lower Deck Saloon

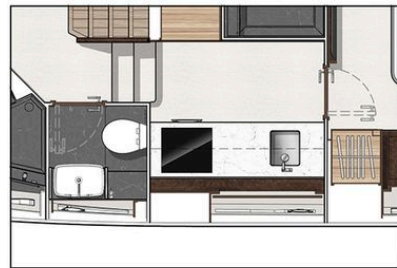

LOWER DECK OPTION

Lower Deck Galley



LOWER DECK OPTION

Port Single Guest Cabin





Your Dedicated Broker

*Sunseeker Spain*

info@sunseekerspain.es  
(+34) 619644247

Spain





Sunseeker Spain, Puerto deportivo de Roses, Local 8-B, 17480  
Tel: +34 972 45 60 98

Sunseeker London Group presents the information and the details of this Vessel in good faith and does not expressly or impliedly guarantee or warrant the accuracy of this information nor expressly or impliedly warrant the condition of the Vessel. All information and details are intended as a guide only and are not binding and do not constitute part of any terms and conditions. A prospective purchasers should instruct his agents, or his surveyors, to investigate such details in order to validate all information. All prospective purchasers should be aware that the "Manufacturers Model Year" varies from builder to builder and does not necessarily correspond to the Vessel's year of build. This Vessel is offered subject to prior sale, price change, or withdrawal without notice. It is noted that this information may be displayed in various languages; however, the interpretation of the language that shall take precedence shall always be UK English.